

Convenient Type Machine Vise

NEW

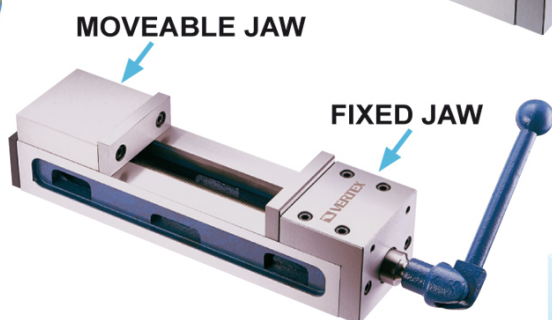

- Moveable jaw located at outer end and align surface for workpiece is in front of operator. It is convenient for loading or unloading workpiece on such design of vise.
- The overall length of this vise is shorter than other similar vises, but keep the more jaw opening. Save space on work table.
- Extra opened
- Semi-spherical segment eliminates jaw lifting and workpiece tilting.
- Time & energy saving
- Width 100 mm opened 180 mm.

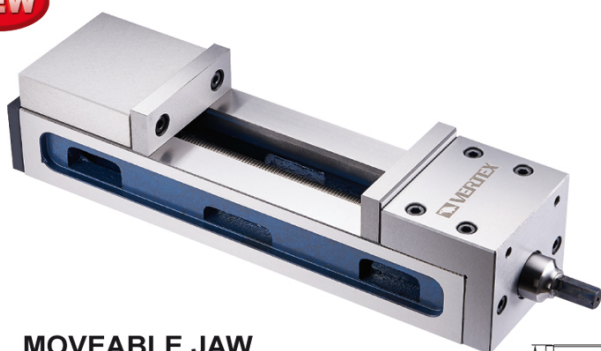
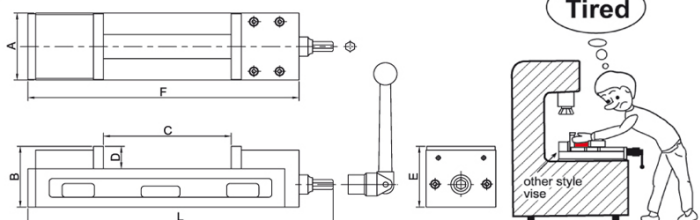

ORDER NO.	A	B	C OPEN	D	E	F	L	Max. Clamp Force (kgf)	Weas (kgs)	CODE NO.
VCM-47	108	98	180	36	62	420	470	450	17.7	4005-080

Super Open Ang-Fixed Machine Vise

NEW

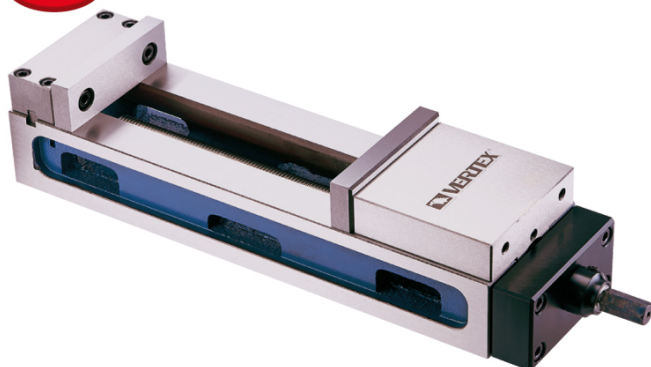

- The overall length of this vise is shorter than other similar vises, but keep the more jaw opening. Save space on work table.
- Semi-spherical segment eliminates jaw lifting and workpiece tilting.
- Vise bed flame hardend to HRC up is capable to obtain low weariness and last the high accuracy for long.
- Chip covers is applied on this vise to prevent from chips falling to leadscrew and inside of vise.
- Width 100 mm opened 210 mm super open.

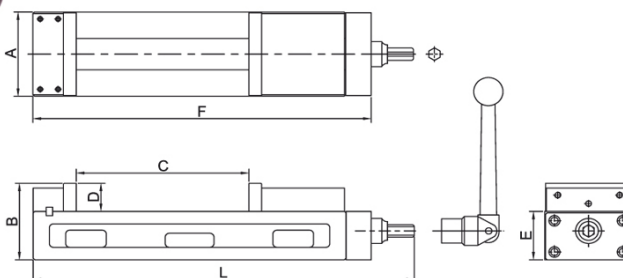

ORDER NO.	A	B	C OPEN	D	E	F	L	Max. Clamp Force (kgf)	Weas (kgs)	CODE NO.
VMC-4L	108	98	203	36	62	420	470	450	17.3	4005-095