

## HSK-A63,A100 Face Mill Holders

DIN69893 A

DIN 69893A

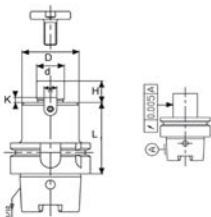

10000 R.P.M. G6.3

ORDER NO.	L	Ød(h6)	ØD	H	K	W	kgs	CODE NO.
HSK-A63-FMA25.4-60	60	25.4	50	20	5	9.5	1.4	3217-140
HSK-A63-FMA25.4-120	120						2.4	3217-141
HSK-A63-FMA31.75-60	60	31.75	60	22	7	12.7	1.6	3217-142
HSK-A63-FMA31.75-120	120						2.6	3217-143
HSK-A63-FMA38.1-60	60	38.1	80	25	9	15.9	2.0	3217-144
HSK-A63-FMA38.1-120	120						3.0	3217-145
HSK-A100-FMA25.4-60	60	25.4	50	20	5	9.5	2.7	3217-146
HSK-A100-FMA25.4-120	120						3.7	3217-147
HSK-A100-FMA31.75-60	60	31.75	60	22	7	12.7	2.9	3217-148
HSK-A100-FMA31.75-120	120						3.9	3217-149
HSK-A100-FMA38.1-60	60	38.1	80	25	9		3.3	3217-150
HSK-A100-FMA38.1-120	120					15.9	4.3	3217-151
HSK-A100-FMA50.8-60	60	50.8	100	28	12		4.1	3217-152
HSK-A100-FMA50.8-120	120						5.6	3217-153

## HSK-A63,A100 Face Mill Holders

DIN69893 A

DIN 69893A

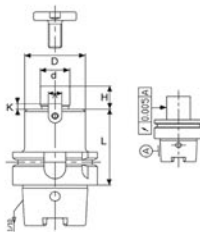

10000 R.P.M. G6.3

ORDER NO.	L	Ød(h6)	ØD	H	K	W	kgs	CODE NO.
HSK-A63-FMB22-50	50	22	48	18	5	10	1.1	3217-156
HSK-A63-FMB22-120	120						2.1	3217-157
HSK-A63-FMB27-60	60	27	60	20	6	12	1.5	3217-158
HSK-A63-FMB27-120	120						2.8	3217-159
HSK-A63-FMB32-60	60	32	72	22	7	14	1.8	3217-160
HSK-A63-FMB32-120	120						3.8	3217-161
HSK-A63-FMB40-60	60	40	80	25	8	16	2.1	3217-162
HSK-A63-FMB40-120	120						3.2	3217-163
HSK-A100-FMB22-50	50	22	48	18	5	10	2.5	3217-164
HSK-A100-FMB22-120	120						3.4	3217-165
HSK-A100-FMB27-60	60	27	60	20	6	12	2.9	3217-166
HSK-A100-FMB27-120	120						4.3	3217-167
HSK-A100-FMB32-60	60	32	72	22	7	14	3.4	3217-168
HSK-A100-FMB32-120	120						5.3	3217-169
HSK-A100-FMB40-60	60	40	80	25	8	16	3.6	3217-170
HSK-A100-FMB40-120	120						6.0	3217-171

MORSE TAPER HOLDERS

## HSK-A63,A100 Sidelock End Mill Holder

DIN69893 A

DIN 69893A

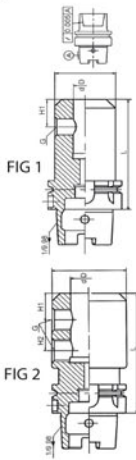

ORDER NO.	L	Ød	ØD	H1	H2	G	FIG	WEIGHT kg	CODE NO.
HSK-A63-SLA6-80	80	6	25	18		M6x0.75	1	0.8	3217-180
HSK-A63-SLA8-80	80	8	28	18		M8x1.0		0.9	3217-181
HSK-A63-SLA10-80	80	10	35	20		M10x1.0		1.0	3217-182
HSK-A63-SLA12-90	90	12	42	22.5		M12x1.5		1.2	3217-183
HSK-A63-SLA14-90	90	14	45	23		M12x1.5		1.3	3217-184
HSK-A63-SLA16-100	100	16	48	24		M14x1.5		1.5	3217-185
HSK-A63-SLA18-100	100	18	50	24		M14x1.5		1.6	3217-186
HSK-A63-SLA20-100	100	20	52	25		M16x1.5		1.7	3217-187
HSK-A63-SLA25-110	110	25	62	24	25	M18x2.0	2	2.2	3217-188
HSK-A63-SLA32-110	110	32	63	28		M20x2.0		2.1	3217-189
HSK-A100-SLA10-80	80	10	35	20		M10x1.0	1	2.4	3217-190
HSK-A100-SLA12-90	90	12	42	22.5		M12x1.5		2.6	3217-191
HSK-A100-SLA16-100	100	16	48	24		M14x1.5		2.9	3217-192
HSK-A100-SLA20-100	100	20	52	25		M16x1.5		3.0	3217-193
HSK-A100-SLA25-110	110	25	64	24	25	M18x2.0	2	3.6	3217-194
HSK-A100-SLA32-110	110	32	72	28		M20x2.0		4.1	3217-195
HSK-A100-SLA40-120	120	40	80	30	32			4.7	3217-196