

## ST-SK Straight Chuck



JIS STD. 15000 R.P.M.

AA

SK

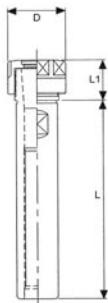

ORDER NO.	TYPE	COLLET	D	L	L1	WEIGHT(kg)	CODE NO.
SKS-210	ST-20-SK6-100	SK6	20	100	20	0.25	3218-660
SKS-211	ST-20-SK6-150	SK6	20	150	20	0.3	3218-661
SKS-212	ST-20-SK10-100	SK10	28	100	20	0.3	3218-662
SKS-213	ST-20-SK10-150	SK10	28	150	20	0.45	3218-663
SKS-214	ST-20-SK10-200	SK10	28	200	20	0.55	3218-664

## Set Of SK Collet And Straight Chuck

JIS STD. 15000 R.P.M.

AA

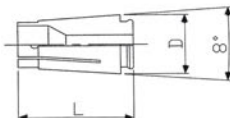

### SK COLLET SET

#### METRIC RANGE SET SIZE

SK06/5pcs : Ø2, 3, 4, 5, 6

SK10/8pcs : Ø3, 4, 5, 6, 7, 8, 9, 10



ORDER NO.	ST TYPE	COLLET	SET RANGE	COLLET SET	WEIGHT	CODE NO.
SKS-231	ST-20-SK6-100	SK6	2-6	5	0.7	3218-670
SKS-232	ST-20-SK6-150	SK6	2-6	5	0.8	3218-671
SKS-233	ST-20-SK10-100	SK10	3-10	8	1.1	3218-672
SKS-234	ST-20-SK10-150	SK10	3-10	8	1.3	3218-673

## SK Nut And Wrench



### SK NUT

ORDER NO.	FIG	COLLET TYPE	D	H	WEIGHT (kg)	CODE NO.
SKN-601	1	SK06	19.5	15	0.05	3218-680
SKN-101	1	SK10	28	17	0.05	3218-681
SKN-161	2	SK16	40	24	0.08	3218-682
SKN-201	2	SK20	50	25	0.1	3218-683
SKN-251	2	SK25	55	30	0.12	3218-684

### SK WRENCH

ORDER NO.	FIG	COLLET TYPE	A	L	WEIGHT (kg)	CODE NO.
SKW-601	1	SK06	18	130	0.08	3218-690
SKW-101	1	SK10	25	140	0.08	3218-691
SKW-161	2	SK16	X	195	0.2	3218-692
SKW-201	2	SK20	X	228	0.22	3218-693
SKW-251	2	SK25	X	228	0.22	3218-694

