

Integrated Type Keyless Drill Chucks

FOR DRILL ONLY, NOT FOR END MILL OR TAP

CAT-TYPE

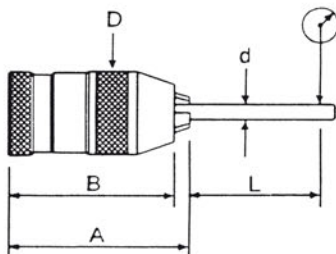

ORDER NO.	Clamping Capacity		Taper	OUTER Ø / mm	WEIGHT (kgs)	CODE NO.
	mm	inch				
INT-8-CAT30	0.5-8	1/64"-1/8"	CAT30	Ø35	0.8	3301-073
INT-13-CAT30	0.5-13	1/64"-1/2"		Ø51.5	1	3301-074
INT-8-CAT40	0.5-8	1/64"-1/8"	CAT40	Ø35	1.32	3301-075
INT-13-CAT40	0.5-13	1/64"-1/2"		Ø51.5	2.1	3301-076
INT-16-CAT40	3-16	1/8"-5/8"	CAT50	Ø58	2.26	3301-077
INT-13-CAT50	0.5-13	1/64"-1/2"		Ø51.5	3.95	3301-078
INT-16-CAT50	3-16	1/8"-5/8"	Ø58	4.2	3301-079	

ACCURACY

ITEM NO.	d mm	L mm	Max Tolerance mm	Torque kgf-cm
INT-8	3	25	0.05	160
	6	30		
	8	30		
INT-10	3	25	0.05	260
	6	30		
	10	30		
INT-13	5	30	0.05	400
	10	25		
	13	25		
INT-16	5	25	0.05	480
	10	30		
	16	30		

KEYLESS DRILL CHUCK

Integrated Type Keyless Drill Chucks

CAN FOR TAP

RL type keyless drill chuck with BT SHANK
SK SHANK
NT SHANK

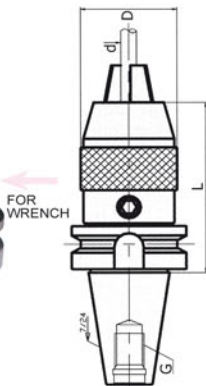

- RL type drill has reinforce torque design to increase more clamping capacity.
- Right turn and left turn allowable.
- No sudden drop when stop or suddenly shift to different direction.
- Highest speed 6000rpm.
- Shorten the shank length which is stronger than traditional design improves the total rigidity.

ORDER NO.	Clamping Capacity mm / d	L	D	G	CODE NO.
BT40-VRL13	0.5-13	95	50	M16	3301-090
BT40-VRL16	3-16	113	57	M16	3301-091
SK40-VRL13	0.5-13	85	50	M16	3301-092
SK40-VRL16	3-16	95	57	M16	3301-093
NT40-VRL13	0.5-13	112	50	5/8"-11unc	3301-094
NT40-VRL16	3-16	120	57	M16	3301-095

Integrated Type Keyless Drill Chucks

FOR DRILL ONLY , NOT FOR END MILL OR TAP



FOR SPECIFICATION PLEASE SEE P.C74

The main-shafts is of integrated type, which is much more superior than the traditional design. The major features are as follows:

- Extremely rigid construction. Accuracy is same as page C66
- The accumulative tolerances can be reduced to a minimum, since the traditional mechanism requiring an ARBOR to connect the Drill Chucks which will generate the accumulative tolerances. The Integrated type Keyless Drill Chuck is designed to solve this problem totally.
- Prevent the Drill Chucks from falling out.
- Extremely safe in operation.
- 2500 R.P.M.

ACCURACY

ITEM NO.	d mm	L mm	Max Tolerance mm	Torque kgf-cm
INT-8	3	25	0.05	160
	6	30		
	8	30		
INT-10	3	25	0.05	260
	6	30		
	10	30		
INT-13	5	30	0.05	400
	10	25		
	13	25		
INT-16	5	25	0.05	480
	10	30		
	16	30		



STANDARD ACCES.

