

## Touch Point Sensor



Edge Finder



VPS-201

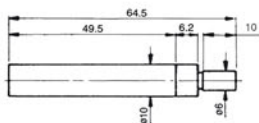

This series is a high precision setting device for positioning the accurate center between tool spindle of machine and reference surface of working at low-cost and saving time.

Accuracy : within  $\pm 0.005$  mm

Made of tool steel, hardened and ground.

Suitable rotation speed : VPS-201 500 to 700rpm.



CREAMIC TYPE VPS-201C



### MECHANICAL TYPE

ORDER NO.	VPS-201	VPS-201C
WEIGHT (KG)	0.03	0.06
CODE NO.	3402-005	3402-007

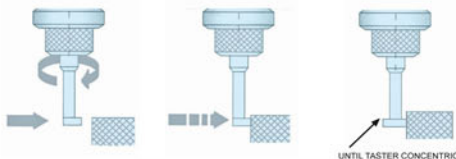

TOUCH POINT SENSOR

## Touch Point Sensor

Deluxe Type



VPS-401



VPS-401C

### FEATURES:

- Material: high-carbon steel.
- Accuracy: within  $\pm 0.003$ mm
- Hardness: HRC  $58 \pm 1$
- R.P.M. Within 600-900
- Suitable for milling machine. Drill machine and boring machine.
- Edge Finder

VPS-401 (2 PCS/SET)  
VPS-402A(LONG) SINGLE  
VPS-402B(SHORT) SINGLE

ORDER NO.	VPS-401	VPS-401C
PCS/SET	2PCS/SET	2PCS/SET
MATERIAL	STEEL	CERAMIC
WEIGHT (KG)	0.26	0.26
CODE NO.	3402-006	3402-008

