

Tailstock For NC Rotary Table

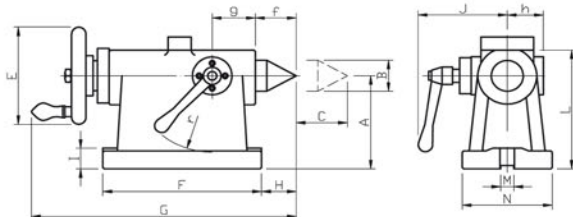

Unit:mm

| Main dimension | | Center height A | Center diameter B | Storke C | pointed end diameter D | Handle diameter E | Base dimensions FXM | G | H | I | J | K | L |
|----------------|---------------------------------|-----------------|-------------------|----------|------------------------|-------------------|---------------------|-----|----|----|-----|----|-----|
| ORDER NO. | For | | | | | | | | | | | | |
| TS-135 | VNCM-150 | 135 | ø45 MT#3 | 55 | ø14 | 125 | 215x120 | 332 | 25 | 25 | 109 | - | 164 |
| TS-135-MT3 | | | | | | | | | | | | | |
| TS-160 | VNCM-220 VNCX-10 VNCM-250 | 160 | ø45 MT#3 | 55 | ø18 | 140 | 230x130 | 356 | 30 | 30 | 129 | 53 | 193 |
| TS-160-MT3 | | | | | | | | | | | | | |
| TS-210 | VNCM-320 | 210 | ø45 MT#3 | 55 | ø18 | 140 | 230x146 | 356 | 30 | 30 | 129 | 53 | 243 |
| TS-210-MT3 | | | | | | | | | | | | | |

Unit:mm

| Main dimension | | Guide block size M | c | u | f | g | h | j | r | Net weight (kgs) | CODE NO. |
|----------------|---------------------------------|--------------------|----|----|----|----|----|----|----|------------------|-----------|
| ORDER NO. | For | | | | | | | | | | |
| TS-135 | VNCM-150 | 18 | 42 | 19 | 40 | 69 | 44 | 70 | 80 | 20.6 | 4002-001 |
| TS-135-MT3 | | | 46 | | | | | | | | 4002-001A |
| TS-160 | | | 49 | | | | | | | | 4002-002 |
| TS-160-MT3 | VNCM-220 VNCX-10 VNCM-250 | 18 | 51 | 19 | 45 | 70 | 52 | 80 | 95 | 23.1 | 4002-002A |
| TS-210 | | | 51 | | | | | | | | 4002-003 |
| TS-210-MT3 | VNCM-320 | 18 | 57 | 23 | 45 | 70 | 52 | 80 | 95 | 29.4 | 4002-003A |

Listed in the above table are examples of applicable models. Those not listed above should be selected so that the center height of the rotary table and dividing heads is the same as that of the tailstock.