

## Quick Change Tool Post American Type

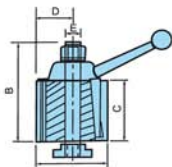

NEW



### QUICK CHANGE TOOL POST WEDGE STYLE

ORDER NO.	SWING FOR LATHE		A		B		C		D		E	CODE NO.
	INCH	MERTIC	INCH	MERTIC	INCH	MERTIC	INCH	MERTIC	INCH	MERTIC		
VTP-F50-11	12	304	2 1/2	63.5	3 3/4	95.25	2 1/4	57.15	1 3/8	34.925	M14X1.5	5006-1141
VTP-F50-22	10-15	255-380	3	76.2	4 3/8	111.125	2 3/4	69.85	1 9/16	39.68	M16X1.5	5006-1142
VTP-F50-33	13-18	330-455	3 1/2	88.9	4 7/8	123.83	3	76.2	1 29/32	48.42	M20X2	5006-1143
VTP-F50-44	14-20	355-505	4	101.6	6	152.4	3 5/8	92.075	2 1/8	53.975	M22X2	5006-1144
VTP-F50-55	17-48	435-1215	5	127	7 3/8	187.32	4 5/8	117.47	2 11/16	68.26	M24X2	5006-1145

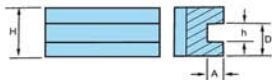

### TURNING AND FACING HOLDER

ORDER NO.	A		D		H		h		CODE NO.
	INCH	MERTIC	INCH	MERTIC	INCH	MERTIC	INCH	MERTIC	
VTP-F50-101	7/16	11.11	15/16	23.81	1 1/2	38.1	1/2	12.7	5006-1151
VTP-F50-201	1/2	12.7	1 1/8	28.57	1 3/4	44.45	5/8	15.87	5006-1152
VTP-F50-301	5/8	15.87	1 7/16	36.51	2 1/8	53.97	3/4	19.05	5006-1153
VTP-F50-401	3/4	19.05	1 11/16	42.86	2 1/2	63.5	1	25.4	5006-1154
VTP-F50-501	1	25.4	3 3/16	55.56	3 1/8	79.37	1 1/4	31.75	5006-1155

Suitable for any size smaller than max. Height h.

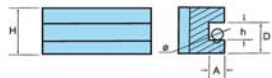

### BORING, TURNING AND FACING HOLDER

ORDER NO.	A		D		H		h		Ø		CODE NO.
	INCH	MERTIC	INCH	MERTIC	INCH	MERTIC	INCH	MERTIC	INCH	MERTIC	
VTP-F50-102	7/16	11.11	15/16	23.81	1 1/2	38.1	1/2	12.7	7/16	11.11	5006-1161
VTP-F50-202	1/2	12.7	1 1/8	28.57	1 3/4	44.45	5/8	15.87	1/2	12.7	5006-1162
VTP-F50-302	5/8	15.87	1 7/16	36.51	2 1/8	53.97	3/4	19.05	5/8	15.87	5006-1163
VTP-F50-402	3/4	19.05	1 11/16	42.86	2 1/2	63.5	1	25.4	3/4	19.05	5006-1164
VTP-F50-502	1	25.4	3 3/16	55.56	3 1/8	79.37	1 1/4	31.75	1 1/8	28.57	5006-1165

Suitable for square and round shank & boring bars.

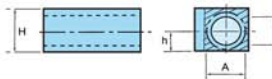

● Split bushing suitable for small boring bars & drill.

### HEAVY DUTY BORING BAR HOLDER

ORDER NO.	A		D		H		h		CODE NO.
	INCH	MERTIC	INCH	MERTIC	INCH	MERTIC	INCH	MERTIC	
VTP-F50-104	3/4	19.05	5/8	15.87	1 1/2	38.1	3/4	19.05	5006-1171
VTP-F50-204	1	25.4	3/4	19.05	1 3/4	44.45	7/8	22.22	5006-1172
VTP-F50-304	1	25.4	3/4	19.05	2	50.8	1	25.4	5006-1173
VTP-F50-404	1 1/4	31.75	1	25.4	2 1/2	63.5	1 1/4	31.75	5006-1174
VTP-F50-504	1 1/2	38.1	1 1/4	31.75	3 1/8	79.37	1 9/16	39.68	5006-1175
VTP-F50-141	1	25.4	3/4	19.05	1 3/4	44.45	7/8	22.22	5006-1176
VTP-F50-241	1 1/4	31.75	1	25.4	2	50.8	1	25.4	5006-1177
VTP-F50-341	1 1/4	31.75	1	25.4	2 1/4	57.15	1 1/8	28.57	5006-1178
VTP-F50-441	1 1/2	31.75	1 1/4	25.4	2 3/4	57.15	1 3/8	28.75	5006-1179