

## Punch Grinder



ORDER NO.V-PGM CODE NO.2002-020

WITH MOTOR TYPE Ø1.5 - Ø25

WEIGHT: 11.8 kgs

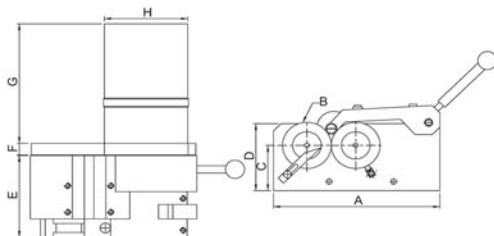

### Features

- 1.High accuracy cylindrical grinding work is possible, just putting this economical unit on surface grinder.
- 2.No center alignment necessary. just put work piece on rollers.
- 3.Portable with single hand, thus easily set up.
- 4.With rollers motor -driven, attention can be concentrated on table/wheel feeds.
- 5.Work can be formed in radius taper as well
- 6.Double roller unit available for long pin or punch grinding.

### FEATURES

Mounting surface(RLxRB).....175 X 218 X 90 mm  
50Hz/220v.....108 rpm  
Roller speed 60Hz/110v.....129 rpm  
Accuracy(Roundness and concentricity).....0.005 mm  
Roller driving motor 110v, Single phase, 25W  
(Specifications are subject to change without notice.)

ORDER NO.	A	B	C	D	E	F	G	H	WEIGHT (kgs)	CODE NO.
V-PGM	174	Ø51	50	74	90	13	132	87	11.8	2002-020

## Punch Grinder

ORDER NO:V-PGA CODE NO.2002-030 WEIGHT:3.1kgs



● Grinding Max. Length 30 mm

● Grinding Max. Length 9 mm

Ø0.5~Ø10

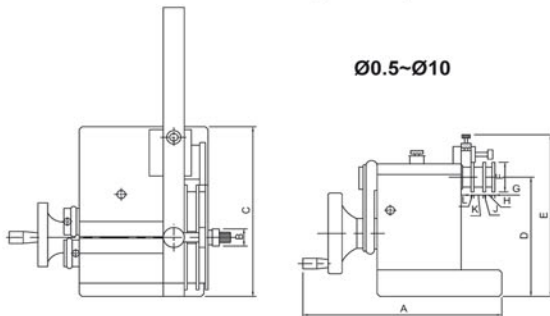

1. The small punch grinder can process from dia 0.5 mm to 6 mm. Smallest workpiece length : 10 mm  
This punch grinder can work with surface grinding machine and to grinding any sizes.
2. Easy operation and high precision make it to be the best grinding tool for small workpiece.

ORDER NO.	A	B	C	D	E	F	G	H	J	K	L	WEIGHT (kgs)	CODE NO.
V-PGA	142	Ø13	128	90	122	22.4	2	4.5	2	6.5	2	3.1	2002-030