

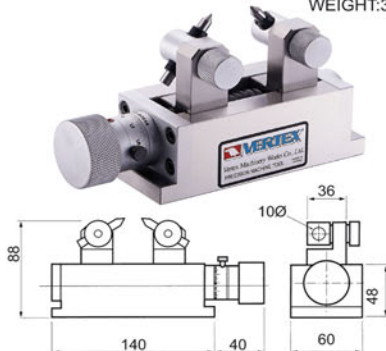

## Precision Duplex Dresser

ORDER NO.V-TDF CODE NO.2012-030

WEIGHT:3.7 kgs



### FEATURES

PRECISION DUPLEX DRESSER is designed to simultaneously dress both sides of a grinding wheel, precisely and without deformation. It is useful for the thinning of grinding wheels or the dressing of thin wheels. manufactured of tool steel and hardened through out to HRC 60 for life time use.

### Specifications:

Max. width of wheel.....40 mm (1-9/16")

Max. dressing depth.....40 mm (1-9/16")

Mini dressing width.....0.2 mm (0.0079")

Graduation.....0.02 mm ( 0.0001")

Max.thickness	Min.	Max.	Min
40mm 	0.2mm 	40mm 	0.02mm/div



## Radius And Angle Dresser

ORDER NO.V-TDG CODE NO.2012-040

WEIGHT:12 kgs

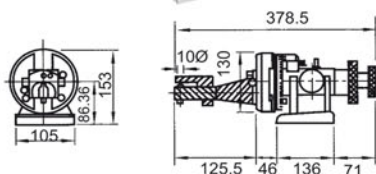

### FEATURES

- 6 minute vernier reading.
- 5-1/2" long x 6-1/2" high.
- Dual purpose knob for drum & angle movement.
- Stop for concave and convex radius.
- Comes with setting gage for diamond tool.
- R CONCAVE = 150 mm
- CONVEX = 60 mm
- MAX. Wheel Dia = 279.4 mm
- Left & Right Stroke = 90 mm

### Specifications:

Max. wheel diameter, standard.....	11"
Concave radius with standard diamonds.....	0-2 1/4"
Concave radius with rta-tail diamonds.....	0-2 1/4"
Convex radius.....	0-4"
Tangent travel in either direction.....	1.950"
Center line.....	3.4"



## Radius And Angle Dresser

ORDER NO.V-TDE CODE NO.2012-050

WEIGHT:9.2 kgs



### Features

- No height gauge or set-up aids required.
- Radius is set on the grinder by measuring over the two pins or by inserting a gauge block for direct reading.
- Concave radius or Convex radius is determined by using either the left or right hand pins.
- Radius = Set the DRESSER on surface grinder measuring by the 2 pins and / or inserting gauge block for direct reading.

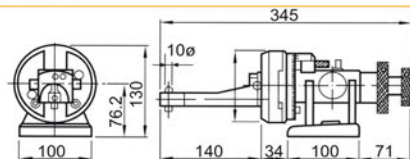

### Grinding wheel dressing application



- R CONCAVE = 100 mm
- CONVEX = 45 mm
- Left & Right Stroke = 65 mm