

3 Jaw Self Centering Chuck

2 Set of Solid Jaw. Plain Back

Normal Type

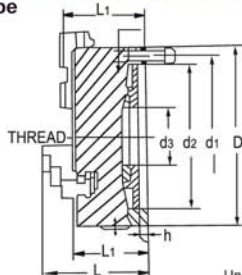

Unit:mm

SPECIFICATIONS

ORDER NO.	D-Size	d1	d2	d3	L	L1	h	THREAD	GRIPPING RANGE		WEIGHT (kgs)	CODE NO.
									O.D. RANGE	I.D. RANGE		
VSC-3A	80mm(3")	66	55	16	66	50	3.5	3-M6	Ø2-Ø70	Ø24-Ø64	2	5002-020A
VSC-4A	100mm(4")	84	72	22	74.5	55	3.5	3-M8	Ø3-Ø90	Ø32-Ø84	3.3	5002-021A
VSC-5A	130mm(5")	115	100	30	78	55	3.5	3-M8	Ø3-Ø110	Ø35-Ø100	5.8	5002-022A
VSC-6A	160mm(6")	142	130	45	95	65	5	3-M8	Ø3-Ø160	Ø48-Ø150	9	5002-023A
VSC-7A	190mm(7½")	172	155	55	105	75	5	3-M10	Ø4-Ø180	Ø56-Ø170	15.1	5002-024A
VSC-8A	200mm(8")	180	165	70	109	75	5	3-M10	Ø4-Ø180	Ø56-Ø170	15.6	5002-025A
VSC-9A	240mm(9½")	215	195	70	122.5	80	5	3-M12	Ø5-Ø220	Ø62-Ø210	26	5002-026A
VSC-10A	250mm(10")	226	206	80	120	80	5	3-M12	Ø6-Ø220	Ø70-Ø250	26.5	5002-027A
VSC-12A	315mm(12")	285	260	100	147.5	90	6	3-M16	Ø10-Ø300	Ø86-Ø290	47	5002-028A
VSC-16A	400mm(16")	368	340	130	173.5	100	6	3-M16	Ø14-Ø400	Ø100-Ø380	73	5002-029A
VSC-20A	500mm(20")	465	440	210	202	115	6	3-M16	Ø25-Ø500	Ø150-Ø500	131	5002-030A
VSC-25A	630mm(25")	595	560	260	194	130	6	3-M16	Ø50-Ø630	Ø170-Ø630	200	5002-031A

3 Jaw Powerful Self Centering Chuck

Reversible Top Jaws. Plain Back

Normal Type

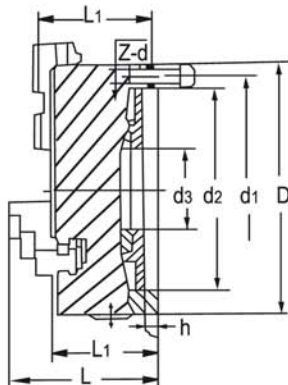
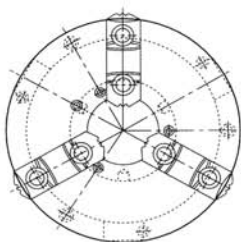

3 JAW SELF CENTERING CHUCK REVERSIBLE TOP JAWS. PLAIN BACK

SPECIFICATIONS

Unit:mm

ORDER NO.	D-Size	d1	d2	d3	L	L1	h	THREAD	GRIPPING RANGE		WEIGHT (kgs)	CODE NO.
									O.D. RANGE	I.D. RANGE		
VSK-6A	160mm(6")	142	130	45	95	71	5	3-M8	Ø8-Ø160	Ø55-Ø150	8.3	5002-040A
VSK-8A	200mm(8")	180	165	65	109	78	5	3-M12	Ø8-Ø180	Ø62-Ø170	16	5002-042A
VSK-10A	250mm(10")	226	206	80	120	84	5	3-M12	Ø12-Ø260	Ø80-Ø250	21.7	5002-043A
VSK-12A	315mm(12")	285	260	100	156.5	102.5	6	3-M16	Ø15-Ø300	Ø90-Ø290	41	5002-043B
VSK-13A	325mm(13")	296	272	100	154.5	102.5	6	3-M16	Ø11.5-Ø350	Ø110-Ø340	45.8	5002-044A
VSK-15A	380mm(15")	350	325	130	156.5	104.5	6	3-M16	Ø11.5-Ø400	Ø110-Ø400	64.7	5002-045A
VSK-16A	400mm(16")	368	340	130	181.5	129.5	6	3-M16	Ø30-Ø470	Ø110-Ø380	75.5	5002-046A