

COPA MANDRIL MANUAL DE 3 MORDAZAS 3-866-1000P



| | | |
|-----------------|-----|----------------|
| Selling Unit | | EA |
| Chuck Type | | SET-TRU Scroll |
| Chuck Size | in | 10 |
| Body Material | | Forged Steel |
| Number of Jaws | | 3 |
| Jaw Type | | 2pc |
| Weight | lb | 81 |
| Mount Type | | Front |
| Gripping Force | daN | 4600 |
| Max RPM | RPM | 2700 |
| Runout (T.I.R.) | in | 0.0006 |

**DIAMETRO DE 10" 250MM
FABRICACION EUROPA**

| | | |
|-----------------------------------|----|--------------|
| Diameter D | in | 9.843 |
| Recess Diameter B | in | 5.709 |
| Recess Depth C | in | 0.787 |
| Hole Diameter E | in | 2.992 |
| Bolt Circle F | in | 8.819 |
| Body Height H | in | 4.291 |
| Jaw Height H1 | in | 2.051 |
| Number of bolts and thread size S | | 3 x M12x1.75 |
| Fine Adjustment Screw n | | 4 x M18x1 |

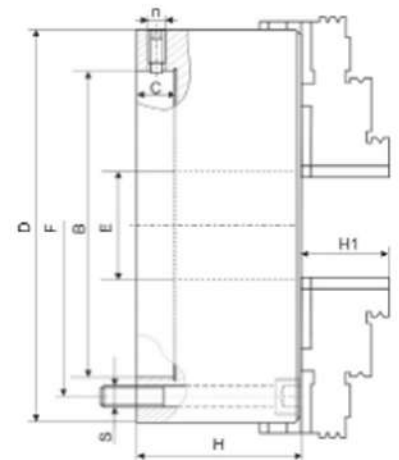

| | | |
|-------------------|----|--------------|
| d1 Solid Jaws | in | 0.197 - 4.65 |
| d1 Two-Piece Jaws | in | 0.197 - 4.65 |
| d2 Solid Jaws | in | 3.03 - 7.40 |
| d2 Two-Piece Jaws | in | 3.39 - 7.76 |
| d3 Solid Jaws | in | 6.30 - 9.84 |
| d3 Two-Piece Jaws | in | 6.30 - 9.84 |
| d4 Solid Jaws | in | 2.44 - 6.85 |
| d4 Two-Piece Jaws | in | 2.28 - 6.50 |
| d5 Solid Jaws | in | 5.71 - 10.08 |
| d5 Two-Piece Jaws | in | 4.92 - 9.25 |

